

NATIONAL COLLECTIONS CENTRE

CARING FOR THE COLLECTION
OF THE SCIENCE MUSEUM GROUP



SCIENCE+
INDUSTRY
MUSEUM

RAILWAY
MUSEUM

SCIENCE
MUSEUM

SCIENCE+
MEDIA
MUSEUM



- Built in 1940 as a maintenance unit for RAF aircraft
- NAVY helicopter repair unit in 1970s
- Large object storage facility for Science Museum in 1979
- Open to the public until 2009
- 545-acres of land
- 75-acres of new woodland
- 80-acres of tarmac
- 5 clusters of buildings

**NATIONAL
COLLECTIONS
CENTRE**



- 10 x 4000m² aircraft hangars
- 1 x 3500m² heated store
- 1x 26,000m² new storage facility
- 35,000 objects from our collection
- 1,500,000 library & archive texts
- Offices, labs and workshops
- 50MW solar farm
- University of Bath research park
- 20+ tenants

**NATIONAL
COLLECTIONS
CENTRE**

Our Vision



A place for conservation, research and learning





A place to work
and visit

Staff accommodation
Accessibility
Look and feel
Visitor experience
Transport

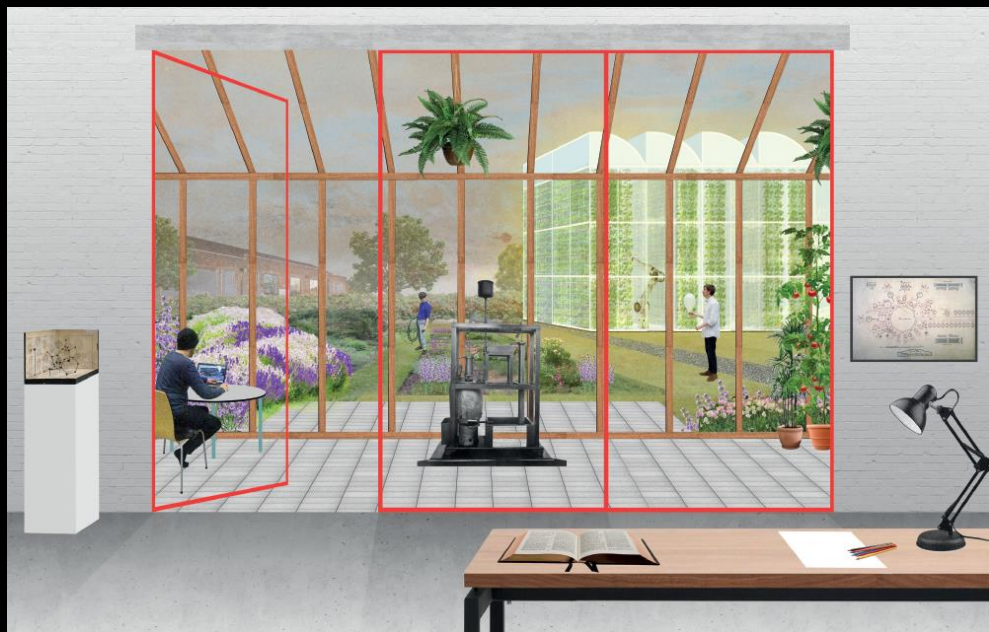



A place for data management, energy storage, manufacturing and developing new products





A place for testing, filming, research & development









WHAT NEXT?

Looking for commercial partners and development proposals for:

- Cultural/Heritage sector storage
- Renewable energy generation
- Energy storage
- Automotive testing (autonomous & EV)
- Data storage
- Technology R&D

Contact matt.moore@sciencemuseum.ac.uk
01793 846229

**NATIONAL
COLLECTIONS
CENTRE**